

## Town of Belle Plaine



# **Dedication Program**

## **Gibson Island**

## **Cloverleaf Lakes**

**July 29, 2006**

*“We the residents and users of Cloverleaf Lakes seek to acquire Gibson Island in order to maintain and protect the Island’s natural environment and wildlife for present and future generations.”*

*Mission of the Gibson Island Project*

Gibson Island Citizens Conservation Project, Inc.

# The Movers and Shakers of the Gibson Island Project

## Gibson Island Citizens Project Board

Stan Kleiss  
Joy Krubsack  
Leeann Little, Treasurer  
Dennis Thornton, Secretary  
Jan Thornton, Chair  
Bob Tomczyk

## Belle Plaine Town Officers

Alvin Bartz, Chair  
Harold Polzin, Supervisor  
Bob Tomashek, Supervisor  
Harriet McCauley, Town Clerk  
Ken Rosenow, Treasurer

## Gibson Island Project Block Captains

Carl and Judy Bruggink  
Rande and Patsy Eggert  
Reid and Mary Hundtermark  
Art Laehn  
Andy and Monica Johnson  
Ed and Becky Johnson  
Dick and Connie King  
Harriet McCauley  
Steve and Kathy McKay  
Dave and Sandy Rosenfeldt  
Debbie and Jerry Selwitschka  
Ben and Leah Smejkal  
Carol Wegner  
Tom and Bonnie Weniger  
Mary and Lee Wetzell  
Don and Jeanne Yeager

## Government Officials

Jim Doyle, Governor of State of Wisconsin  
P. Scott Hasset, Secretary of Wisconsin  
Department of Natural Resources  
Robert Cowles, State Senator  
John Ainsworth, State Assemblyman  
Sandy Polzin, County Board Supervisor

## *Heartfelt Thanks Go To . . .*

*The Cloverleaf Lakes Protective Association for stepping up to the plate and setting an example for giving and support.*

***Matt Duncan**, who originated and continually updated our stunning website.*

***Todd Lukoski**, whose Clintonville class projects resulted in high quality brochures and stationery.*

***Kery and Russ Kafka**, silent auction directors, originators of the “Gibson Girls” and much more.*

***Susan Kocken and Chris Halbur** of the DNR who shepherded the grant proposal through the process and answered many questions.*

***Ben Keigley**, dedicated “phone-a-thon” coordinator, who made 200 phone calls on behalf of the Project.*

***Jan Kleiss, Dennis Krubsack, Nick Little and Judy Tomczyk** for steadfast support and help in so many ways throughout the Project’s duration.*

***Dick Kunz**, creator and artist for the striking “thermometer” sign that charted the progress of the Gibson Island Project at the boat landing.*

***Peter McKeever** of Heart Lake Conservation Associates, Monona, who got us started, gave us courage and provided a framework for success.*

***Sandy Tomashek** for helping write lots of grants.*

***Carol Wegner** for being the “star” Block Captain.*



*Never doubt that a small group of thoughtful, committed citizens can change the world. Indeed, it is the only thing that ever has.*

*-Margaret Mead (1901-1978)*

**Town Chairman Alvin Bartz, left, and Gibson Island Project board members Bob Tomczyk, Joy Krubsack, Leeann Little, Jan Thornton, Dennis Thornton and Stan Kleiss.**

Cover photo courtesy of Coldwell Banker Hilgenberg Realtors, Shawano

# Town of Belle Plaine

## ***Program***

### ***Dedication of Gibson Island***

***11 a.m., Saturday, July 29, 2006***

***Cloverleaf Lakes, Town of Belle Plaine, Shawano County, Wisconsin***

***Emcee Alvin Bartz, Chairman, Town of Belle Plaine***

***Invocation***, Jim Schmidt, Director, Imago Dei Village/Crossways Camping Ministry

***Welcome and Introduction of Noted Guests***, Alvin Bartz

***State Greetings***, Jean Rombach-Bartels, DNR Northeast Region Lands Leader

***Words of Congratulations***, Assembly Representative John Ainsworth

***Congratulations from the Cloverleaf Lakes Protective Association***, Jim Aumann

***Dedication of Gibson Island***, Alvin Bartz

***Dedication of Gary Lenius Trail***, Alvin Bartz and Lynne Lenius

***Reflections from the Gibson Island Project***, Jan and Dennis Thornton

***Town Hall Plaque Presentation***, Joy Krubsack and Leeann Little

***Island Monument Presentation***, Stan Kleiss and Leeann Little

***Special Awards***, Bob Tomczyk and Joy Krubsack

***Final Comments***, Alvin Bartz

***Adjournment to Popp's Lake Aire for Celebration and Dutch Treat Lunch***

Gibson Island Citizens Conservation Project, Inc.

# *The Generous Donors to the Gibson Island Project*

*“Donate Once, Benefit Forever”*

## **Bald Eagle (\$50,000 or more)**

**Land and Water Conservation Fund**, a National Park Service Program administered in this state by the Wisconsin Department of Natural Resources

**Gary and Lynne Lenius**

**Town of Belle Plaine**

## **Hawk (\$25,000 or more)**

**Anonymous**

*In memory of Jane Gibson Stieg* by **Robert Stieg Sr., Marge Stieg Miller, Robert Stieg Jr., and Dr. Philip Stieg**

*In memory of Mrs. Margaret Thomas* by **Dr. Lewis Thomas, Mark Thomas, and John Thomas**

**Carol A. Wegner**

## **Blue Heron (\$10,000 or more)**

**American Marine and Motor Sports – Tony and Lugene Zielinski**

**Cloverleaf Lakes Protective Association**

**The Jim and Nancy Green Family**

**Dennis and Jan Thornton**

**Stockbridge-Munsee Band of Mohican Indians**

## **Loon (\$5,000 or more)**

*In memory of Jerry Altman* by **Bradley and Paula Clark Russ and Kery Kafka**

**Thomas and Barbara Kivlin**

**Stan and Jan Kleiss**

**The Marvin and Esther Letven Family**

**Edwin and Mary Jane Renaud**

**Myron and Gaye Tassoul**

## **Sand Hill Crane (\$1,000 or more)**

**David and Marilyn Aldrich**

**Anonymous**

*In memory of SSgt. Warren Hansen* by **Anonymous**

**James and Jana Aumann**

**Autumn Longbeards Chapter, National Wild Turkey Federation**

## **Sand Hill Crane (con't.)**

**Alvin and Nancy Bartz**

*In memory of Jerry Altman* by **Daniel and Dolores Bleck**

**Charles and Mary Ann Bose**

**Carl and Judith Bruggink**

**Norman and Annette Burton**

**The Cottage** (Geary/Stangel/Ponyicsanyi)

**Dr. Jeffrey and Gwen Casperson**

**Cloverfest Run/Walk 2005**

**Bill and Pat DeGuire**

*In memory of Lorne and Dorothy Doan* by **Kris Doan**

**William Dolinar and Lisa Vukovich**

**Rande and Patsy Eggert**

**Robert and Barbara Gayhart**

**Kevin, Dar and Kersten Godfrey**

**The Hilgenberg Families**—Neil and Vera, Phil and Kathy and Terry and Bonnie

**Reid and Mary Hundertmark**

**Andy and Monica Johnson**

**Geno and Khris Johnson**

**The Jay and Shirley Johnson family** *in loving memory of Charlie and Mabel (Schmidt) Perrin* of Pair - in Pines.

**Anton and Marlene Karcz**

**Klein Chevrolet-Buick-Pontiac**

**Dennis and Joy Krubsack**

**Gerhard and Eva Krubsack**

**Phillip and Mary Krueger**

**Nick and Leeann Little**

**Dale Mahlik Agency**

**Allen and Pat Mahnke**

*In memory of George and Margaret McCauley* by **Harriet McCauley**

**The Mijal Family**

**Edward B. Miller**

**Thomas and Beverly Miller**

**Monroe Family Ltd. Partnership**

**Audrey Nolan**

**Peter and Sanny Oberhauser**

*In memory of LaVera Korb* by **Richard and Mary Lee Odders,**

**Olson's Rural Electric Inc.**

**Jim, Carlene and Jeff Orr**

**Popp's Lake Aire**

**Thomas and Beverly Rosenfeldt**

**Christopher and Carolyn Sampson**

**Peter and Patricia Sesing**

**James and Dorothea Smith**

**James A. Sommer**

**The Donald Sorenson Family**

**Richard and Marilyn Stieg**

**Richard and Mitzi Thurow**

**Bob Tomashek and Fran West-Tomashek**

**John Torborg**

**The Howard Unrath Family**

**William and Donna Varney**

**Wal-Mart**

**Roy and Kathy Weiner**

**Jack Ziegler**

## *The Generous Donors to the Gibson Island Project*

### Mallard Duck (up to \$999)

Geraldine Abrahamson

Anonymous

Anonymous

Anonymous

Clayton and Barbara Anderson

Greg and Midge Anunson

Associated Bank

Belle Plaine Cheese Factory

Luciano and Sarah Benavides

Julian and Joan Berman

William and Rosemary Bonifay

John and Mary Beth Born

Mark Buth

Robert and Andrea Buth

Helen M. Carnes

Calvin and Catherine Caro-Bruce

Capitol Legal Investigations, Inc.

Kenneth and Amy Colton

Chad and Jennifer Cook

Robert Crabb

Marshall and Sandra Crowther

Marin and Sarah Deluca

Mary Doan

Gerald and Sue Ann Dohr

Cameron and Jennifer Dunn

Jacqueline Dunn

Randy and Linda Eisel

Alan and Bonnie Erickson

Gertrude Eshleman

Todd and Bonnie Everson

John and Jacquelyn Fandrey

Mary Fischer

Michael and Shirley Fischer

Michael and Charlotte Fixler

Craig and Donna Ford

Eric and Suzanne Fowle

Fox Communities Credit Union

Ann M. Schafer Fuge

Salud Garcia and Pamela Kleiss

Ellen M. Gerkens

Geoffrey Gerrits

Ginny Gribble

Theresa Grosse

Wayne and Carolyn Hansen

Phillip Harsh

Don Heiman Builders LLC

*In memory of James H. Horn and Henry J. Horn by*

Mary M. Horn

James and Kathy Jesse

Craig Johanesen

Luoine Kafka

Randall and Vicki Keigley

Ann Kesting

William and Patricia Kinzinger

Steven and Munira Kleiss

Shirley Knitt

Riva Korashan

Irene M. Korth-Marquardt

Anna Krubsack

David and Karen Krubsack

Vilas and Donna Krueger

Richard and Donna Kunz

Arthur H. Laehn

Christine LaNasa

Elizabeth A. Lawhun

David Lemmenes

Donna Loesl

Cory and Roseann Mason

Dr. Donald and Mary Mayek

Joseph and Bridget Mayek

John and Larue McKay

Steven and Kathleen McKay

Mid-West Neon Supply Co.

Howard and Lavonne Millard

Kim Miller

Ronald and Laverne Miller

John and Rosemary Monroe

Rosalind Moore

David and Linda Morack

Michael and Lynn Mulholland

Harry and Lois Niese

Dennis and Kathy Nodolf (The Nodolf Living Trust)

Noritage, Inc

M. O'Connell

Marvin B. Olson

Jennie Pluger

John and Dejon Polzin

Richard K. Renaud

Russell and Katherine Rill

D.J. Rohrer Community Fund of the Clintonville

Area Foundation

David and Sandra Rosenfeldt

Carl and Arlene Ruscitti

Bonnie Sielaff

Ellen Sielaff

Jonah Sielaff

Nathan Sielaff

Veryle and Virgie Sievert

Susan Skaros

Benjamin and Leah Smejkal

Ken and Karen Sojka

Mark Speckhard M.D.

Scott W. Stieg

Ed and Addie Stuebe

Alfred and Irmgard Swanson Jr.

Ann Syriopoulos

Scott and Jodi Tilleson

Robert and Judy Tomczyk

Carl and Bertha Anne Topie

James and Julie Topie

Paul and Rae Tyriver

*In memory of Mary M. Weiner by Roy and Kathy Weiner*

Loyal and Donna Weishoff

Willet and Leone Weller

Tom and Bonnie Weniger

Lee and Mary Wetzel

Joyce Wiese

Roger and Judie Wilson

Bob and Judi Wysocki

Bruce and Mary Yaeger

## *Timeline History*

### *Gibson Island Citizens Conservation Project, Inc.*

1990

Town of Belle Plaine Town Planning Committee identifies Gibson Island as a “high priority natural area.”

1998

Town identifies Island in its Land Use and Development Plan.

2000

Town places the Island in its Comprehensive Outdoor, Open Space and Recreation Plan.

2003

December 13 - Meeting with Island Owner Lynne Lenius during which she expresses support for the Gibson Island Project.

December 17 - Introductory meeting for citizens at Belle Plaine Community Center with Consultant Peter McKeever of Heart Lake Conservation Associates.

2004

January 1 - Petition drive begins that collects more than 300 signatures in support of the Gibson Island Project.

January 8 - Project unanimously endorsed by the Board of the Cloverleaf Lakes Protective Association.

January 12 - First meeting of the core group of citizens that eventually becomes the Board of Directors of the Gibson Island Project: Stan Kleiss, Joy Krubsack, Leeann Little, Dennis Thornton, Jan Thornton and Bob Tomczyk. This group meets 53 times over the next 2-1/2 years to achieve the mission: *“We the residents and users of Cloverleaf Lakes seek to acquire Gibson Island in order to maintain and protect the Island’s natural environment and wildlife for present and future generations.”*

February 2 - Gibson Island Citizens Conservation Project officially incorporated as a Wisconsin nonstock corporation under Ch. 181 of the Wisconsin Statutes.

February 2 - Memorandum of Agreement approved by Belle Plaine Town Board establishing a segregated Town bank account for tax-deductible contributions to the Project, and agreeing to take ownership of Island if acquisition is successful and to keep the Island natural forever.

February 3 - Town/Gibson Island Project bank account established at Associated Bank, Embarrass. Fund raising begins for operational expenses such as appraisal, consultant fees, earnest money, postage, printing and supplies.

February 28 and March 6 - Public informational meetings held at Belle Plaine Community Center.

April 28 and May 1 - Organizational meetings with Gibson Island Block Captains.

July 20 - Island appraisal received valuing the Island at \$1.030 million. Negotiations begin with Lynne Lenius and her real estate representative, Terry Hilgenberg.

2005

April 10 - Purchase agreement reached with Island owner Lynne Lenius for \$1.025 million (with Mrs. Lenius contributing \$200,000 at closing). Capital fund raising campaign begins.

May 1 - Application submitted to the Wisconsin Department of Natural Resources for Knowles Nelson Stewardship Grant funding.

July 1 - Word received from the DNR that the Gibson Island Project is rated No. 1 in the state in its category and that \$416,000 will be awarded from the Land and Water Conservation Fund, a National Park Service program.

July 25 - Special Town Meeting approves the Gibson Island purchase agreement and the plan to sell a town-owned vacant lot on Pine Lake with proceeds to go toward the Project.

2006

January 16 - Bids for town-owned Pine Lake lot opened. Winning bid is \$131,101.02.

March 3 - Formal closing on the property.

March 30 - Final payment made to Mrs. Lenius.

April 10 - Town Board appoints advisory Gibson Island Stewardship Committee.

July 29 - Gibson Island Dedication and Celebration.

## *Financial Details of the Gibson Island Project*

### Total Contributions from Fund Raising

February 2004 through June 2006

**TOTAL** **\$298,364.93**

### Expenditures of Monies Raised

\$ 278,573.00	Purchase of the Island
*7,427.53	Real estate fee and expenses for sale of town lot
3,233.00	Consultant fees
3,100.00	Appraisal of Gibson Island
2,100.00	Island Monument (est.)
1,300.00	Town Hall Plaque (est.)
300.00	Dedication expenses (est.)
1,455.50	Postage, printing and supplies
<b><u>TOTAL</u></b>	<b><u>\$297,489.03</u></b>

\*Half of real estate fee donated back to the Project.

### Other Funds Received

\$416,000 Land and Water Conservation Fund (LAWCON), National Parks Service  
 \$200,000 Contribution at closing from Island owner  
 \$130,427 Proceeds from sale of town-owned lake lot  
 \$ 12,000 Contribution from Stockbridge-Munsee Band of the Mohican Indians, for stewardship of the Island

### Purchase Details

\$ 278,573	Gibson Island Project Fund Raising
416,000	LAWCON grant
200,000	Donation from Island owner
130,427	Proceeds from sale of town lot
<b><u>\$1,025,000</u></b>	<b><u>Purchase Price of Gibson Island</u></b>

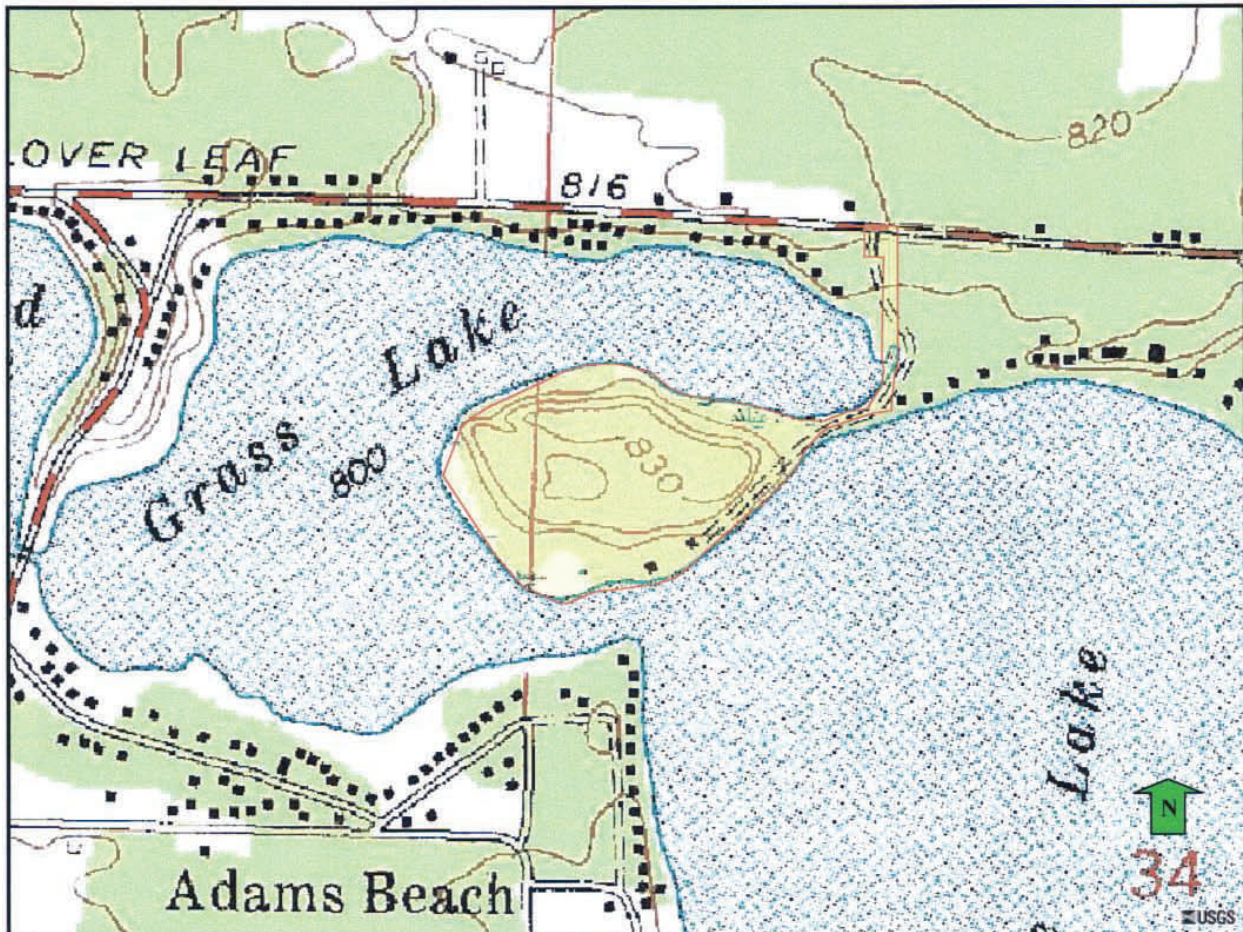



## **Future Plans**

The Town's Gibson Island Project bank account will be closed. The Town will establish a Gibson Island Stewardship Committee bank account and any remaining funds from the Gibson Island Project account will be transferred into this new account. This will bring closure to the Gibson Island Citizens Conservation Project and, with it, the start of a new era of protection and stewardship of the Island forever. Tax-deductible donations may be made to the Stewardship Account.

**Stewardship Committee** members include Barry Anker, Alvin Bartz, Nancy Green, Stan Kleiss, Joy Krubsack, Dennis Thornton, Dick Thurow, Allan Waelchi, and Fran West.